

The Pennsylvania stone farmhouse had its beginnings in the 1700s, when a great wave of German immigrants arrived in Penn's colony. The new settlers cleared the fields for farms, harvesting the native stone for building homes in an adaptation of a German vernacular style.

## The Cobbler



*rear*



*front*

### Summary

First floor: 1584 sf	3 bedrooms, 3 1/2 baths	Covered porches: 547 sf
Second floor: 1532 sf	Finished area: 3115 sf	Unfin. basement: 1229 sf

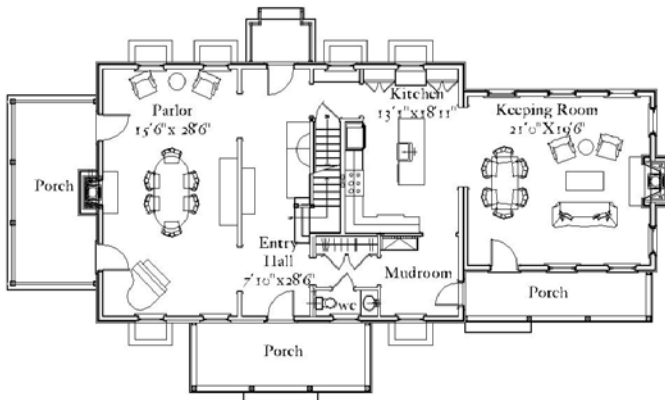

*first floor*

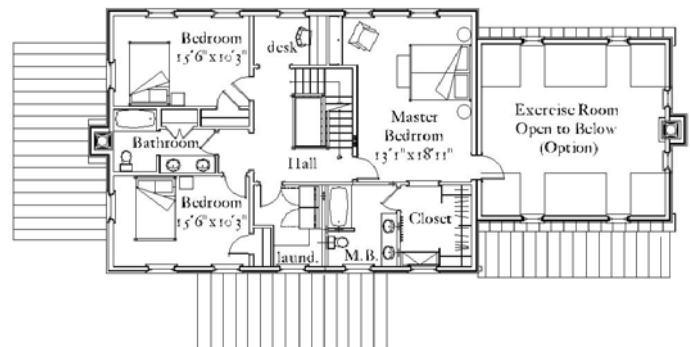

*second floor*